

HSV Filter Housings

Vent applications

ENERGOEKONOM
spol. s r.o.



- Direct connection to tank boss allows housing to be self-supportive
- Easy assembly and maintenance
- STANDARD product
 - Standard surface finish and tri-clamp connection
- PLUS product
 - Available as STANDARD or for ATEX applications
 - Standard, sanitary and sanitary electropolished surface finishes available
 - Connection choices

(Also see HSVLP L-Port Datasheet)

Specification

STANDARD Range

Materials of Construction

Housing:	316L Stainless Steel
Seals:	Silicone FDA
Clamps:	304 Stainless Steel

Surface Finish

Internal:	As welded
External:	Polished 0.8 µm Ra (32 µln Ra)

All finishes pickled and passivated

PLUS Range

Materials of Construction

Housing:	316L Stainless Steel
Seals:	EPDM FDA Silicone FDA Viton™ / FKM FDA

Note: Seal used only to position bowl clamp arrangement.

Clamps:	304 Stainless Steel
---------	---------------------

Standard Surface Finish

Internal:	As welded Pickled and Passivated
External:	Polished 0.8 µm Ra (32 µln Ra)

Sanitary Finish

Internal:	Polished 0.4 µm Ra (16 µln Ra)
External:	Polished 0.25 µm Ra (10 µln Ra)

Sanitary Electropolished Finish

Internal:	Polished 0.4 µm Ra (16 µln Ra) and Electropolished
External:	Polished 0.25 µm Ra (10 µln Ra)

Welding

All assembly welds are full penetration.
All welds are crevice and undercut free.
Weld finish and detail drawings available upon request.

Certification

Supplied as standard with vessel inspection certificate

Material Test Certification

EN10204 3.1 supplied upon request.

Recommended Operation Guidelines

Sizing

Sizing vent vessels particularly for vacuum sensitive tanks can require specialist advice. It is important that VENT housings are sized on maximum gas flow capacity under actual operation conditions.

Vacuum Protection

Where a tank is vacuum sensitive, there is a risk of tank collapse. In such cases the fitting of an appropriately rated bursting disc (or similar) and, if necessary a pressure relief valve, is highly recommended.

Approvals

EAC 010-2011, (No. TC N RU D-GB. AИ01.B.00511)
Approval type: Import Certificate, TRCU
Pressure Equipment (available on request)



Physical Characteristics

Bowl Height	Dimensions (mm)			Typical Weight
	'A'	'B'	'C'	
A Size 125 mm [5"]	75 mm [2.9"]	195 mm [7.7"]	130 mm [5.1"]	1.0 Kg [2.2lbs]
B Size 65 mm [2 1/2"]	75 mm [2.9"]	140 mm [5.5"]	70 mm [2.8"]	0.9 Kg [1.9lbs]
125 mm [5"]	132 mm [5.2"]	242 mm [9.5"]	194 mm [7.6"]	2.2 Kg [4.8 lbs]
250 mm [10"]	132 mm [5.2"]	392 mm [15.4"]	313 mm [12.3"]	2.8 Kg [6.1 lbs]
500 mm [20"]	132 mm [5.2"]	642 mm [25.3"]	561 mm [22.1"]	3.8 Kg [8.3 lbs]
750 mm [30"]	132 mm [5.2"]	890 mm [35.0"]	809 mm [31.8"]	4.8 Kg [10.6 lbs]
1000 mm [40"]	132 mm [5.2"]	1138 mm [44.8"]	1057 mm [41.6"]	5.8 Kg [12.8 lbs]

Dimensions shown are based on the STANDARD range. For accurate dimensions, please contact Parker donnick hunter.

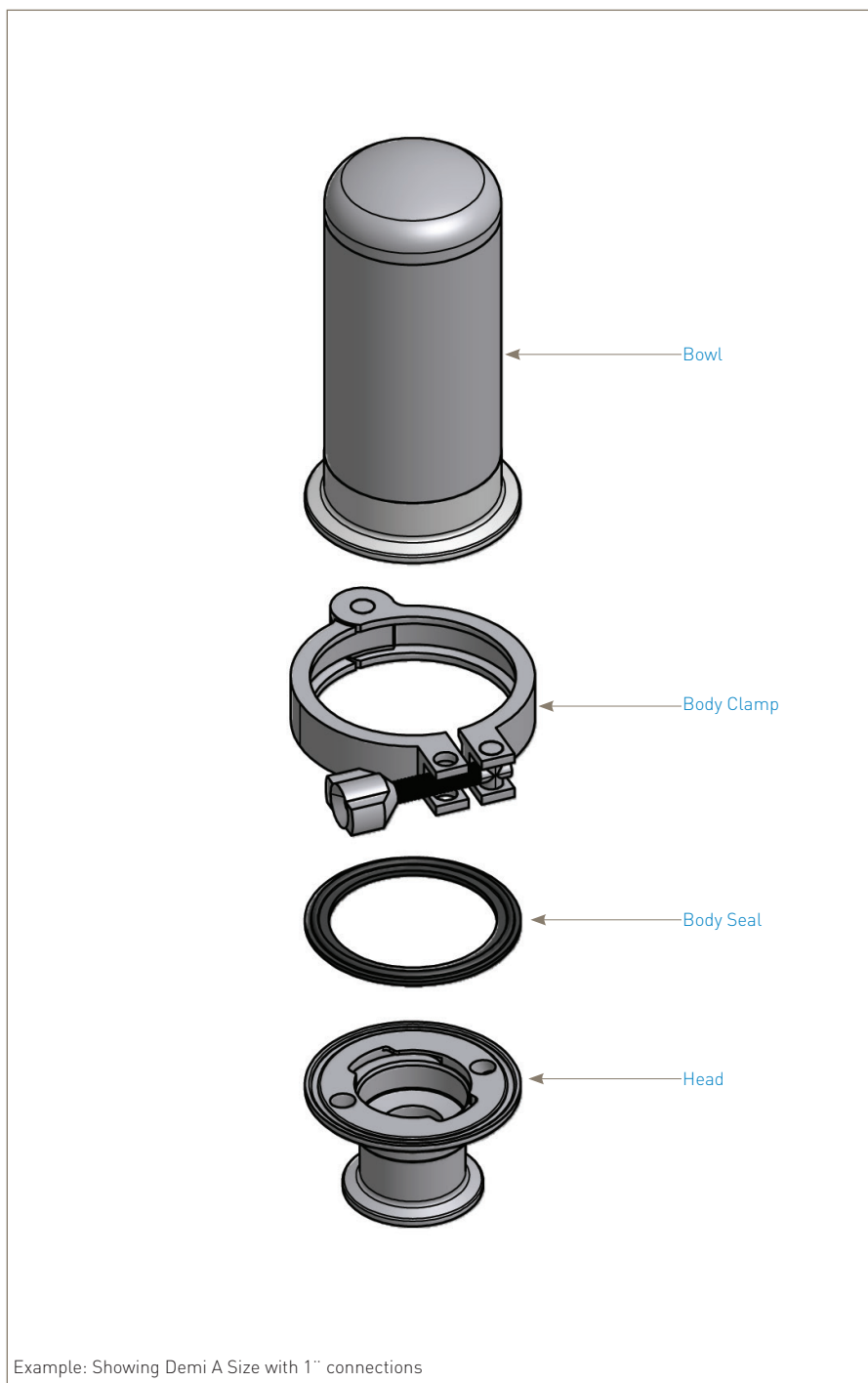
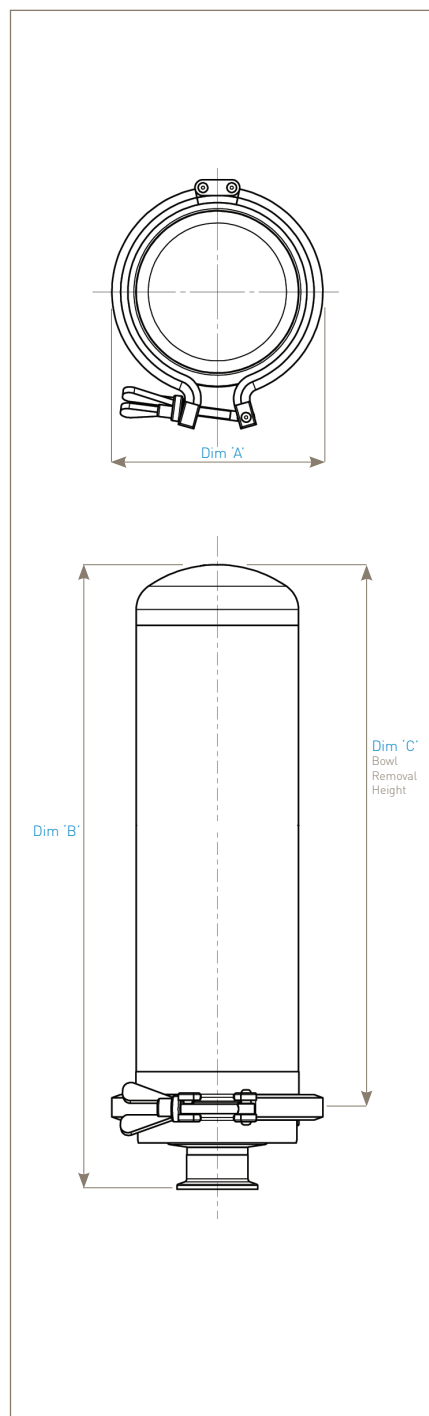

Example: Showing Demi A Size with 1" connections

The PLUS product range is available with many options of connections, vents, drains, surface finish, seals classification, etc. Please see product coding.

Note: All housings are full vacuum rated.

DS_FBH_07_04/16Rev. 1C

HSV Filter Housings

Vent applications

ENERGOEKONOM
spol. s r.o.



STANDARD Range - K to 20"

HSV		01				-		-	
Code Vessel Class	Code Length (Nominal)	Code Connection Size	Code Standard	Code Cartridge	Code Seal				
DH Vent Housing	K 5" (125 mm) 1 10" (250 mm) 2 20" (500 mm)	Y 1 1/2" (38.1 mm)	T Tri-Clamp®	C 226	S Silicone				

STANDARD Range - Demi A & B

HSV		01				-		-	
Code Vessel Class	Code Length (Nominal)	Code Connection Size	Code Standard	Code Cartridge	Code Seal				
DH Vent Housing	A 5" (125 mm) B 2 1/2" (65 mm)	B 1" (25.4 mm)	T Tri-Clamp®	T 126	S Silicone				

PLUS Range - K to 40"

HSV			01						-		-						
Code Vessel Class		Code Length (Nominal)		Code Connection Size		Code Standard		Code Cartridge		Code Seal		Code Surface Finish		Internal	External	Code Tagged	
DH	Standard	K	5" (125 mm)	C	2" (50.8 mm)	B	BSPP / ISO 228	C	226	E	EPDM	B	Sanitary	0.4 µm	0.25 µm	T	Yes
AT	ATEX	1	10" (250 mm)	Y	1 1/2" (38.1 mm)	D	DIN11851(M)			P	PTFE	I	Standard	As Welded	0.8 µm	X	No
		2	20" (500 mm)			F	ANSI RF150			S	Silicone	P	Sanitary Electropolished	0.4 µm EP	0.25 µm		
		3	30" (750 mm)			L	EN 1092-1			V	Viton™ / FKM						
		4	40" (1000 mm)			N	PN16										
						T	NPT										
						W	Tri-Clamp®										
							Butt Weld										
							BS4825 Pt. 1										

For Tagged Options customer identification numbers required at time of ordering

PLUS Range - Demi A & B

HSV			01						-		-				
Code Vessel Class		Code Length (Nominal)		Code Connection Size		Code Standard		Code Cartridge		Code Seal		Code Surface Finish		Internal	External
DH	Standard	A	5" (125 mm)	B	1" (25.4 mm)	B	BSPP / ISO 228	T	126	E	EPDM	B	Sanitary	0.4 µm	0.25 µm
AT	ATEX	B	2 1/2" (65 mm)			D	DIN11851(M)			P	PTFE	I	Standard	As Welded	0.8 µm
						F	ANSI RF150			S	Silicone	P	Sanitary Electropolished	0.4 µm EP	0.25 µm
						L	EN1092-1			V	Viton™ / FKM				
						PN16									
						N	NPT								
						T	Tri-Clamp®								
														Code Tagged	
														T	Yes
														X	No
For Tagged Options customer identification numbers required at time of ordering															

Stäubli™ is a trademark of Stäubli AG.

Stäubli™ is a trademark of Stäubli AG.

Tri-Clamp® is a trademark of Alfa-Laval, Inc.

Viton™ is a registered trademark of DuPont Performance Elastomers L.L.C..

Note: All Tri-Clamp® connections conform to BS4825 Pt. 3

Parker domnick hunter has a continuous policy of product development and although the Company reserves the right to change specifications, it attempts to keep customers informed of any alterations. This publication is for general information only and customers are requested to contact our Process Filtration Sales Department for detailed information and advice on a products suitability for specific applications. All products are sold subject to the company's standard conditions of sale.

DS_FBH_07_04/16Rev. 1C